

## Room Dimensions & Capacities

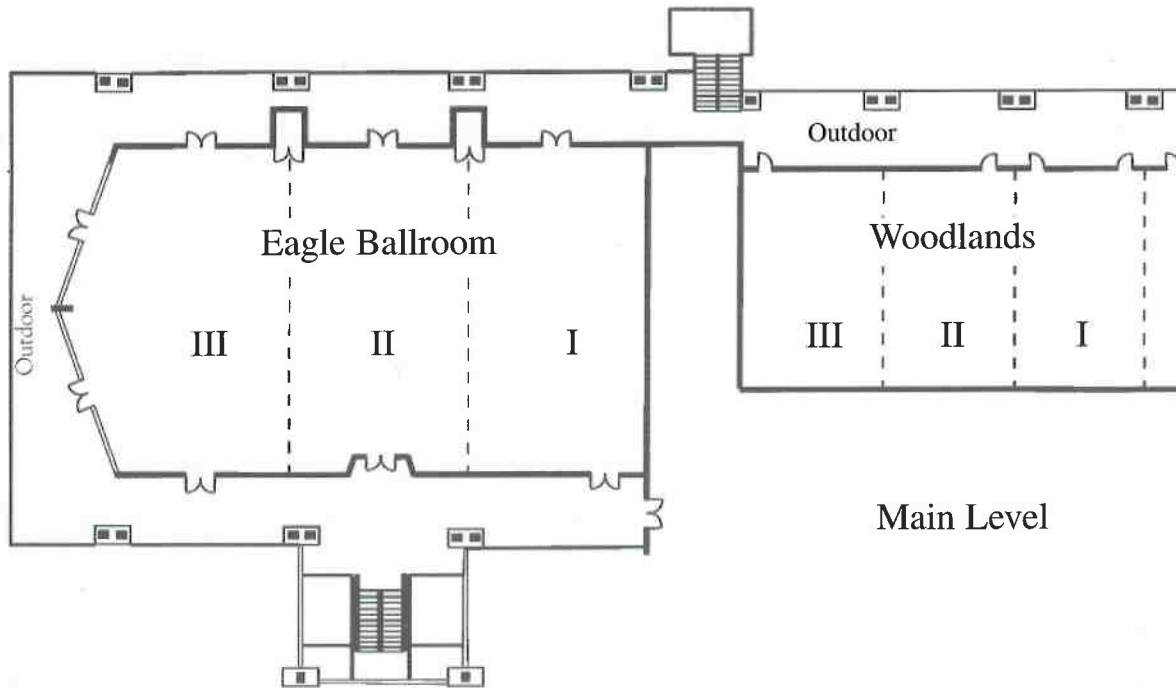

Main Level

### Eagle Ballroom Rooms I through III Main Level

Ceiling	Eagle I	Eagle II	Eagle III	Eagle 2 Combo	Eagle 3 Combo
12' - 22'	57' x 31'	54' x 31'	57' x 31'	57' x 62'	57' x 93'
(at peak)	1767 sq. ft.	1674 sq. ft.	1767 sq. ft.	3534 sq. ft.	5301 sq. ft.
Classroom	100	100	100	240	360
Hollow Square	70	55	70	94	132
U-Shape	58	48	58	71	103
Board of Directors	48	38	48	54	88
Theatre	150	150	150	350	600
Rounds	120	120	120	250	400

### Woodlands Private Dining Rooms I through III Main Level

Ceiling	Woodlands I	Woodlands II	Woodlands III	2 Combo	3 Combo
9' - 12'	21' x 16'	21' x 16'	21' x 16'	21' x 32'	21' x 48'
	336 sq. ft.	336 sq. ft.	336 sq. ft.	672 sq. ft.	1008 sq. ft.
Classroom	24	24	24	48	72

### Patios With Meal Functions

40' x 60'	South Pro Shop	North Pro Shop	East Point Patio	East Pro Shop
Point Patio (Tented April - October)		(Tented April - October)		
150	Patio 28, Inside 30	Patio 20, Inside 24	80	Patio 16, Inside 20

## Room Dimensions & Capacities

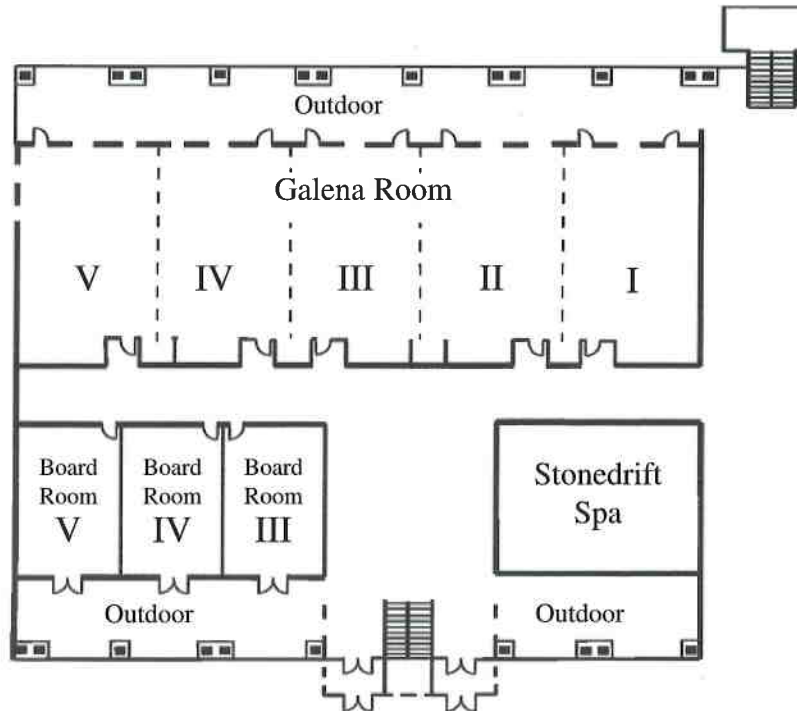

Lower Level

### Galena Rooms I through V Lower Level

Ceiling 10'	I Room	2 Combo	3 Combo	4 Combo	5 Combo
		30' x 22' 660 sq. ft.	30' x 44' 1320 sq. ft.	30' x 66' 1980 sq. ft.	30' x 88' 2640 sq. ft.
Classroom	32	84	132	180	228
Hollow Square	30	52	76	94	118
J-Shape	23	40	65	83	99
Board of Directors	22	38	48	72	96
Theatre	56	120	210	294	378
Rounds	40	90	140	200	250

### Board Rooms III through V Lower Level

Ceiling 10'	Board Room III	Board Room IV	Board Room V
		24' x 26' 384 sq. ft.	24' x 26' 384 sq. ft.
Hollow Square	22	22	22
U-Shape	14	14	14
Board of Directors	16	16	16
Theatre	30	30	30
Rounds	24	24	24